

AT A GLANCE

FEATURES

- Durable heavy chrome finish
- Simple rugged compact design
- Available with or without throttle brake
- STB complete with adjustable friction damper
- Control suits 33C type cables or 4300 type cable

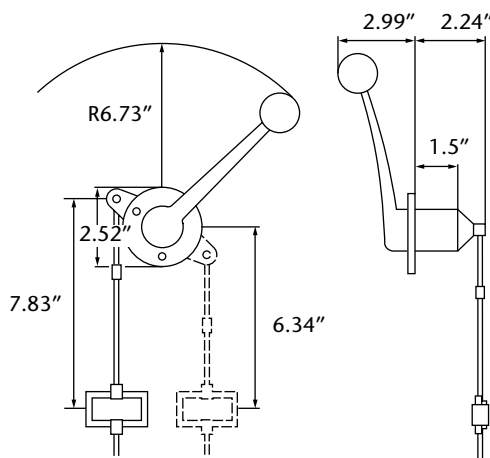

ST AND STB FLUSH/SIDE MOUNT CONTROLS

TECHNICAL DATA

Single function, single lever control simple trouble free design. The time proven design of these controls means years of reliable operation. Suits 33C or 43C type cable.

SPECIFICATIONS

ENGINE CONTROLS	PART NO.
ST Control with no brake (3300 and 4300 control cables) (Old #'s 031791 or 039115)	CH2400P
STB w/external brake (3300 and 4300 control cables) Old #'s 044777 or 045978	CH2410P

ACCESSORIES AND PARTS	PART NO.
Black ball knob	4009819**
Stainless steel shift knob (smooth)	CA69051P**
Mounting hardware kit	062279

COMPATIBLE CABLES	PART NO.
OEM/Univ. 3300/33C Types	
Universal 3300 Types	
3300/33C cable (standard)	CC172XX/CC230XX
3300/33C cable (midrange)	CC332XX
TFXTREME 3300/33C cable (premium)	CCX633XX
Universal 43 Types	
TFXTREME 43BC cable	CCX430XX
TFXTREME 43C cable	CCX433XX

**Fits most controls with 3/8-24 threaded levers

